



## Insulated Concrete Forms (ICF)

Great form. Great finish.  
Some buildings sell themselves.

ICF strength and the great look of Sto is always a winning combination. Sto ICF Finish systems are your single-source solution for irresistible curb appeal for the longer lasting beauty of your buildings. Sto's full line of architectural coatings, finishes and specialty finishes means your design possibilities are endless.

# Sto provides you with more colors and more shapes for the most appealing buildings.

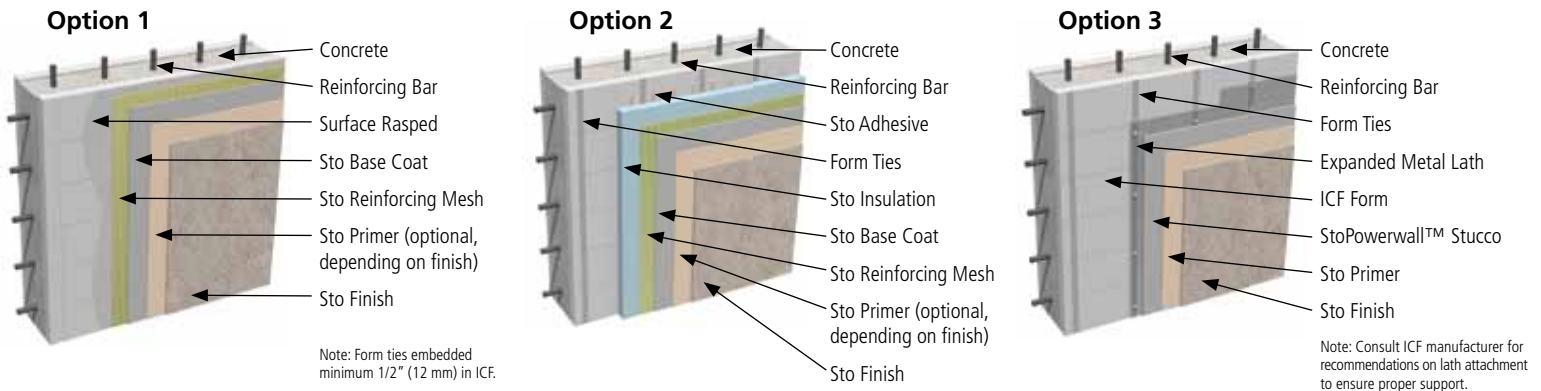

**Option 1: Coating System** Recommended when the walls are straight and flat with little leveling needed and ties are embedded at least 1/2 inch inside the ICF form.

**Option 2: StoTherm System** Recommended when the walls are NOT straight and flat with greater need for leveling and ties are NOT at least 1/2 inch inside the foam. Also recommended when additional insulation is desired: to promote energy efficiency, building codes now require continuous insulation (ci) on building exteriors. Adding additional ci can satisfy this need, depending on the building's climate zone.

**Option 3: Stucco Coating System** Recommended when a harder surface is preferred.

## Sto offers a variety of architectural coatings and textured finishes, including a line of specialty finishes.



### Sto Architectural Coatings and Finishes

Sto has you covered in a wide range of beautiful, durable finishes for a strong, flexible layer of protection. Our finishes are manufactured in ISO-certified facilities to meet extremely strict quality control standards, contain pure white marble aggregate and 100% acrylic polymers, and come in virtually unlimited colors.

### Specialty Finishes

Sto's line of artistic, protective finishes provide the look you want including brick, granite, stone, limestone and metal panels.

### Lotus-Effect® Finishes

Featuring Lotus-Effect® technology, a patented breakthrough technology modeled on the unique self-cleaning lotus leaf, Sto Lotusan finishes and coatings are incomparable to any exterior product on the market. Like the lotus leaf, the finish is rinsed clean with rainfall, thereby reducing maintenance costs.



### Sto Studio

Our internal color design consultative group, Sto Studio, is available to help you break away from the competition. We can provide architectural renderings of possible color options to assist in your contract pursuits and to help you achieve the look desired by your customers.

Contact your Sto Sales Representative for more information.

Please visit us at [www.stocorp.com](http://www.stocorp.com) or call us toll-free at **800-221-2397**.

To view key design details for using Sto with insulated concrete forms, visit us on the web at [www.stocorp.com](http://www.stocorp.com).

### Sto Corp.

3800 Camp Creek Parkway  
Building 1400, Suite 120  
Atlanta, GA 30331

Phone: 404-346-3666  
Toll Free: 1-800-221-2397  
Fax: 404-346-3119

[www.stocorp.com](http://www.stocorp.com)



#### ATTENTION

Sto products are intended for use by qualified professional contractors, not consumers, as a component of a larger construction assembly as specified by a qualified design professional, general contractor or builder. They should be installed in accordance with those specifications and Sto's instructions. Sto Corp. disclaims all, and assumes no, liability for on-site inspections, for its products applied improperly, or by unqualified persons or entities, or as part of an improperly designed or constructed building, for the nonperformance of adjacent building components or assemblies, or for other construction activities beyond Sto's control. Improper use of Sto products or use as part of an improperly designed or constructed larger assembly or building may result in serious damage to this product, and to the structure of the building or its components. STO CORP. DISCLAIMS ALL WARRANTIES EXPRESSED OR IMPLIED EXCEPT FOR EXPLICIT LIMITED WRITTEN WARRANTIES ISSUED TO AND ACCEPTED BY BUILDING OWNERS IN ACCORDANCE WITH STO'S WARRANTY PROGRAMS WHICH ARE SUBJECT TO CHANGE FROM TIME TO TIME. For the fullest, most current information on proper application, clean-up, mixing and other specifications and warranties, cautions and disclaimers, please refer to the Sto Corp. website, [www.stocorp.com](http://www.stocorp.com).